



LS302/LS302C



LS303/LS303C



LS304/LS304C



LS307-2/LS307-2C

Applications:

Obstruction light for a wide variety of cranes used in Harbors, Metallurgies, Towers (Telecom, GSM), Smokestacks, Buildings and any other potentially hazardous obstructions to air traffic with a steady burning red safety light.

Main functions and features.

- Die casting aluminum enclosure with powder-coat paint finishes, providing corrosion resistance and durability.
- Use LED cluster as bulb, the life is more than 100,000 hours.
- Self-contained compartment, with stainless steel wire which is used to secure the unit against falling in operation, and ease of mount.
- Sealed construction, can withstand the harsh effects of the environment.
- Built-in micro monitoring controller unit, when and if the service light fails the controller switch on the standby light automatically(optional)
- Built-in photocell can switch ON/OFF the light at dawn and dusk (optional).
- Service and standby function(optional)
- Flashing mode or steady burning is available.
- Lamp housing –Polycarbonate, with good anti-impact strength, thermal stability, high transmittance
- Extremely Reliable — Major Maintenance Cost Saving

Specifications:

Standard	Compliant to the ICAO (Aerodromes Annex 14)	Vertical degree:	≥10°
Light source	LED	Horizontal degree:	360°
LED color	Aviation red	Flashing rate	30 times/min
Operating voltage:	AC110V~AC240V/DC40V~DC60V (optional)	LED life	≥100,000h
Power consumption:	See model selection	On/off level	50Lux
Working mode	Steady burning or flashing mode	Intensity	See model selection
Operating temperature	-30°C ~ +70°C	IP Protection	IP65
Relative humidity	10% ~ 95% (no condensing)	Weight	<4kg
Material	Base: Die casting aluminum, housing: PC		

Installation and Operation

1. Verify whether the supply voltage complied with the rated voltage of the light
2. Secure the light fitting on the top of a machine or lighthouse using G3/4" (G1 ") pipe (secure the light reliably against falling in operation.)
3. Open the junction box cover, connect power cable and earth wire to corresponding terminals and then remount the cover.
4. Power on after verification of connection, the service light will light up, if and when the service light fails, the controller will switch on the standby light, at this moment, the maintenance worker should check and replace the service light as early as possible.



LS308/LS308C

Mounting dimension (unit : mm)

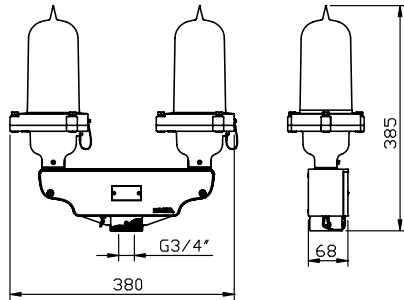

LS302/LS302C/LS303/LS303C

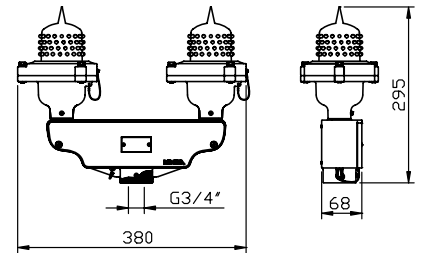

LS304/LS304C

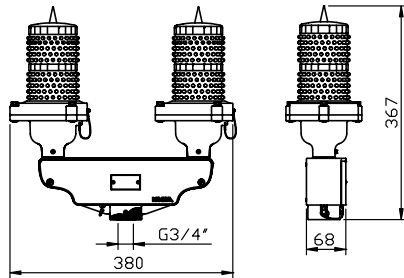

LS307-2/LS307-2C

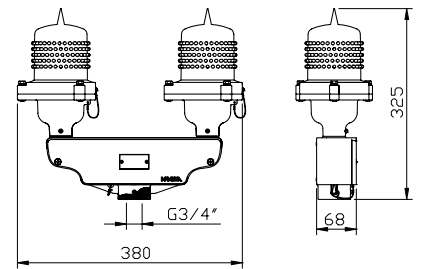

LS308/LS308C

Application



Model selection

Model	Power consumption(single light)	Intensity	Visible distance	Nos of working light
LS302	< 5W	> 10cd	> 3.6km	2
LS302C	< 5W	> 10cd	> 3.6km	1
LS303	4W	> 10cd	> 3.6km	2
LS303C	4W	> 10cd	> 3.6km	1
LS304	4W	> 10cd	> 3.6km	2
LS304C	4W	> 10cd	> 3.6km	1
LS307-2	12W	> 45cd	> 6km	2
LS307-2C	12W	> 45cd	> 6km	1
LS308	8W	> 32.5cd	> 5km	2
LS308C	8W	> 32.5cd	> 5km	1

Notice

- Check whether the power cables are connected correctly before power on
- Temperature rise inside the control box is normal phenomenon
- Please do not open any components inside by yourself
- This product is a sealed structure; Should not be tampered with by anyone other than registered installer
- Please use this product strictly on accordance with the instruction above